

NOTE:
 1. SEE SHEET L8 FOR PLANTING SCHEDULE, LEGEND, NOTES, & ABBREVIATIONS.
 2. WHERE REFERENCED AS CIVIL PLANS/DWG'S REFER TO SHEETS PP1-PP14. (ALL SHEETS WHEN SHOWN)

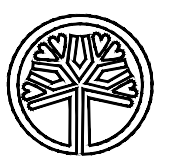

STATE OF WASHINGTON
 LICENSED LANDSCAPE ARCHITECT
 JULIET B. VONG
 LICENSED NO. 857
 EXPIRES ON _____

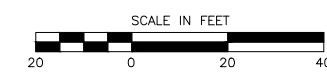
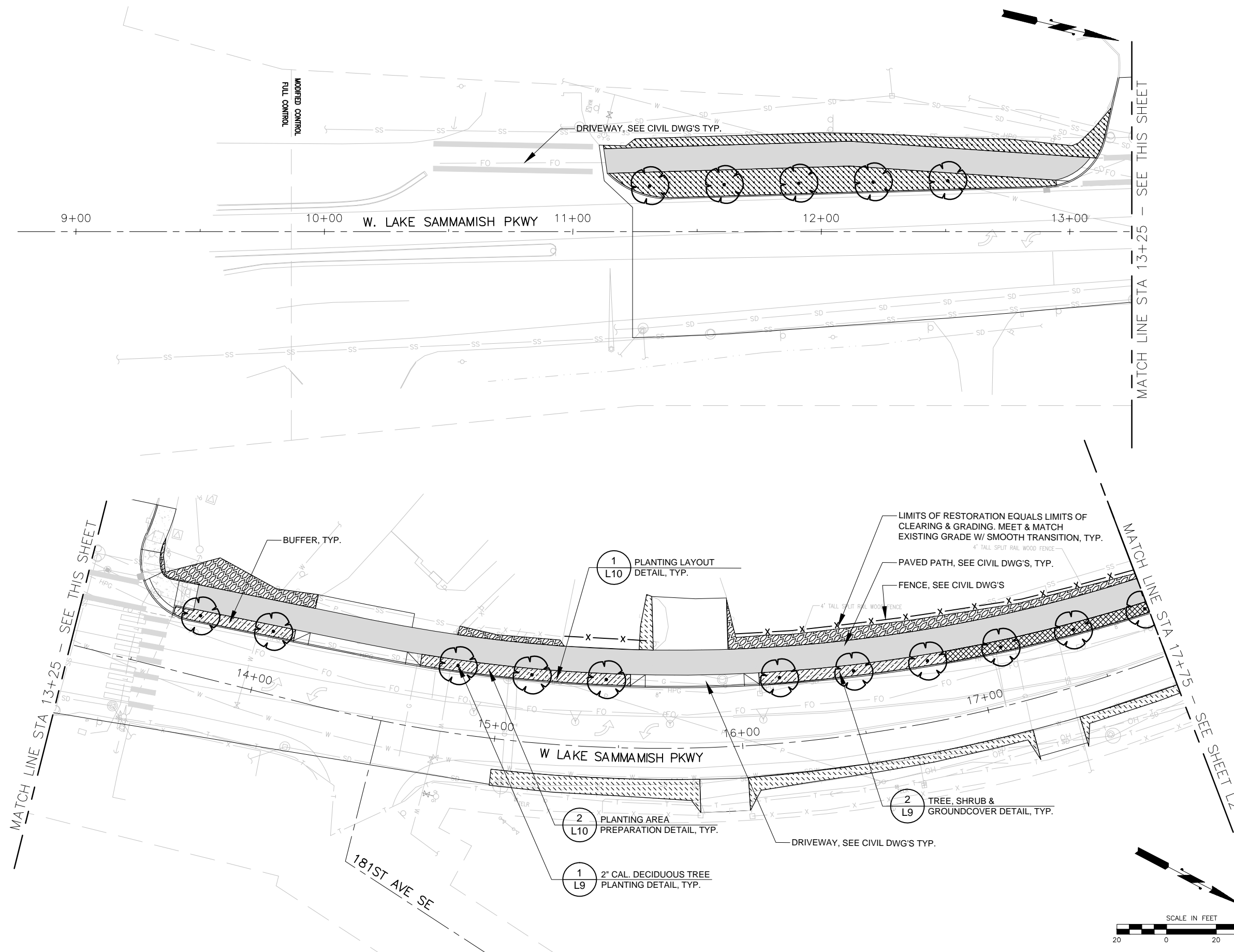

CALL 48 HOURS BEFORE YOU DIG
 1-800-424-5555

100% SUBMITTAL

PLANTING PLAN

L1 SHT 87 OF 108

08/06/2012 2:52pm P:\2011 Projects\2011-04\Graphics\AutoCAD\100% Final\1-PL01.dwg

NO.	DATE	BY	APPR.	REVISIONS

Approved By
 TRANSPORTATION DESIGN MANAGER DATE
 PROJECT MANAGER DATE

ARL DESIGNED BY AUG 2012 DATE
 ARL/MLT DRAWN BY AUG 2012 DATE
 JLH CHECKED BY AUG 2012 DATE



Reid Middleton
 728 134th Street SW - Suite 200
 Everett, Washington 98204
 Ph: 425 741-3800

WEST LAKE SAMMAMISH PARKWAY
 IMPROVEMENTS PROJECT - PHASE 1

NOTE:
 1. SEE SHEET L8 FOR PLANTING SCHEDULE, LEGEND, NOTES, & ABBREVIATIONS.
 2. WHERE REFERENCED AS CIVIL PLANS/DWG'S REFER TO SHEETS PP1-PP14. (ALL SHEETS WHEN SHOWN)

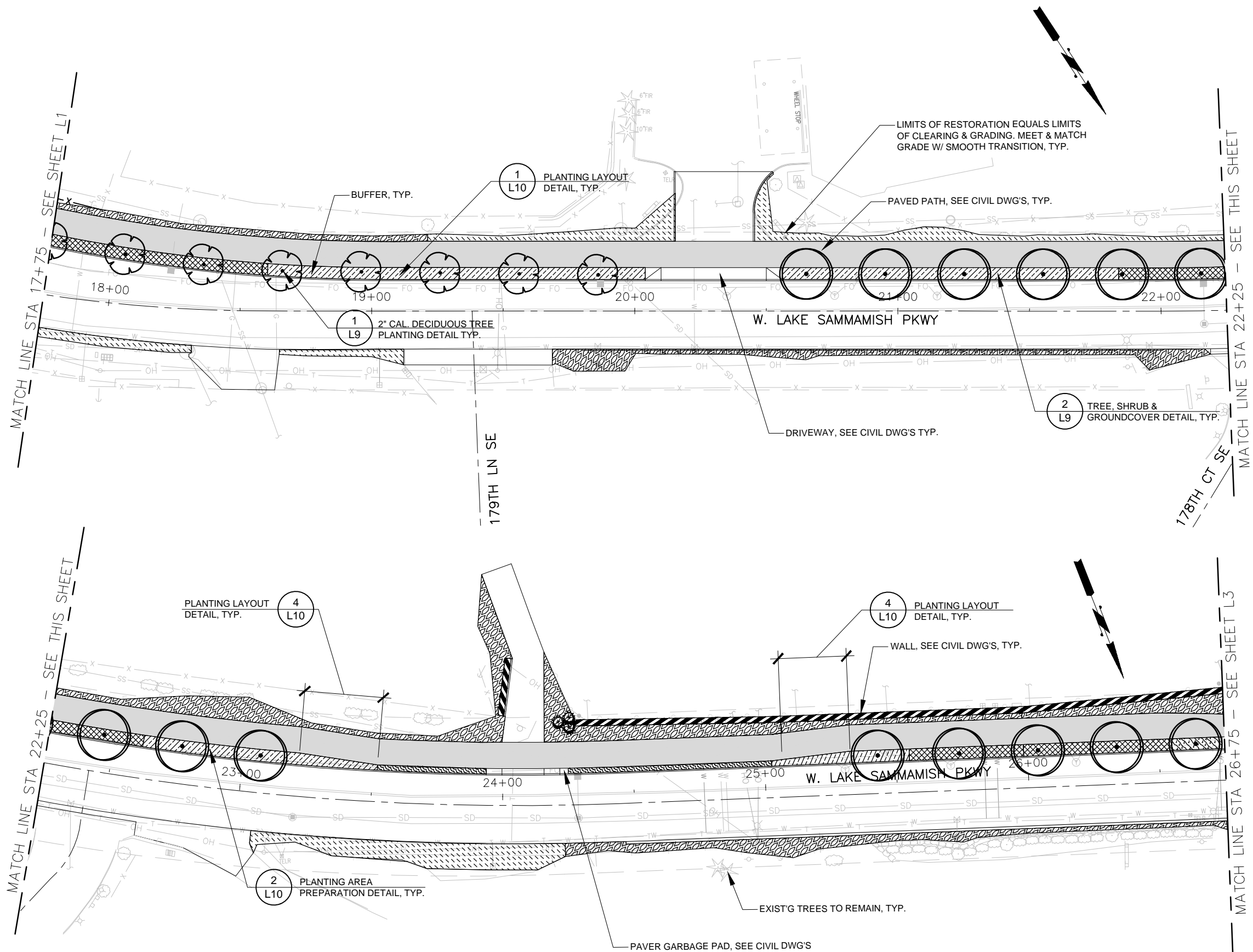

STATE OF WASHINGTON
 LICENSED LANDSCAPE ARCHITECT
 JULIET B. VONG
 LICENSED NO. 857
 EXPIRES ON _____



CALL 48 HOURS BEFORE YOU DIG
 1-800-424-5555

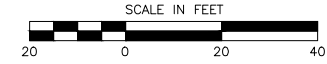

08/06/2012 2:52pm P:\2011 Projects\2011-04\Graphics\AutoCAD\100% Final\1-PL01.dwg

NO.	DATE	BY	APPR.	REVISIONS

Approved By
 TRANSPORTATION DESIGN MANAGER DATE
 PROJECT MANAGER DATE

ARL DESIGNED BY AUG 2012 DATE
 ARL/MLT DRAWN BY AUG 2012 DATE
 JLH CHECKED BY AUG 2012 DATE



Reid Middleton
 728 134th Street SW - Suite 200
 Everett, Washington 98204
 Ph: 425 741-3800

WEST LAKE SAMMAMISH PARKWAY
 IMPROVEMENTS PROJECT - PHASE 1

100% SUBMITTAL

PLANTING PLAN

L2 SHT 88 OF 108

NOTE:
 1. SEE SHEET L8 FOR PLANTING SCHEDULE, LEGEND, NOTES, & ABBREVIATIONS.
 2. WHERE REFERENCED AS CIVIL PLANS/DWG'S REFER TO SHEETS PP1-PP14. (ALL SHEETS WHEN SHOWN)

MITIGATION AREA CONSTRUCTION SEQUENCE & NOTES:

1. FIELD VERIFY & CLEARLY MARK LIMITS OF WETLAND AS SHOWN ON PLANS PRIOR TO CONSTRUCTION.
2. PROVIDE REINFORCED SILT FENCE AROUND WETLAND AND MITIGATION PLANTING, SEE COB STANDARD DWG EC-5.
3. ENGINEER TO MARK ALL EXISTING NATIVE TREES AND SHRUBS WITHIN THE MITIGATION AREA.
4. USING HAND-HELD TOOLS, BRUSH CUT ALL NON-NATIVE INVASIVE VEGETATION THROUGHOUT THE MITIGATION AREA.
5. REMOVE HIMALAYAN BLACKBERRY ROOTS AND ROOT CROWNS TO A DEPTH OF 6" BELOW GRADE THROUGHOUT THE MITIGATION AREA. DISPOSE OF ROOT AND CUT CANES OFF SITE. SEE DETAIL 4/L9.
6. DO NOT USE HERBICIDES IN THE MITIGATION AREA.
7. LAY CARDBOARD OVER AREAS CLEARED. DO NOT COVER NATIVE TREES AND SHRUBS.
8. AVOID COMPACTING SOILS AND EROSION. DO NOT DRIVE TRACTORS OR MOWERS OR OTHER WHEELED VEHICLES IN THE WETLAND MITIGATION AREA.
9. PLANTS TO BE LOCATED IN FIELD BY ENGINEER.
10. PLANT PER TREES, SHRUB & GROUNDCOVER DETAIL IN EXIST'G SOIL, SEE DETAIL 2, SHEET L9.
11. SPREAD 4" DEPTH OF BARK MULCH OVER ENTIRE MITIGATION AREA. KEEP MULCH OFF OF PLANT STEMS AND FOLIAGE.

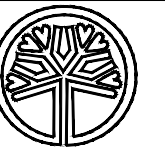

STATE OF WASHINGTON
 LICENSED
 LANDSCAPE ARCHITECT

JULIET B. VONG
 LICENSED NO. 857
 EXPIRES ON _____



CALL 48 HOURS BEFORE YOU DIG
 1-800-424-5555

100% SUBMITTAL

PLANTING PLAN

L3 SHT 89 OF 108

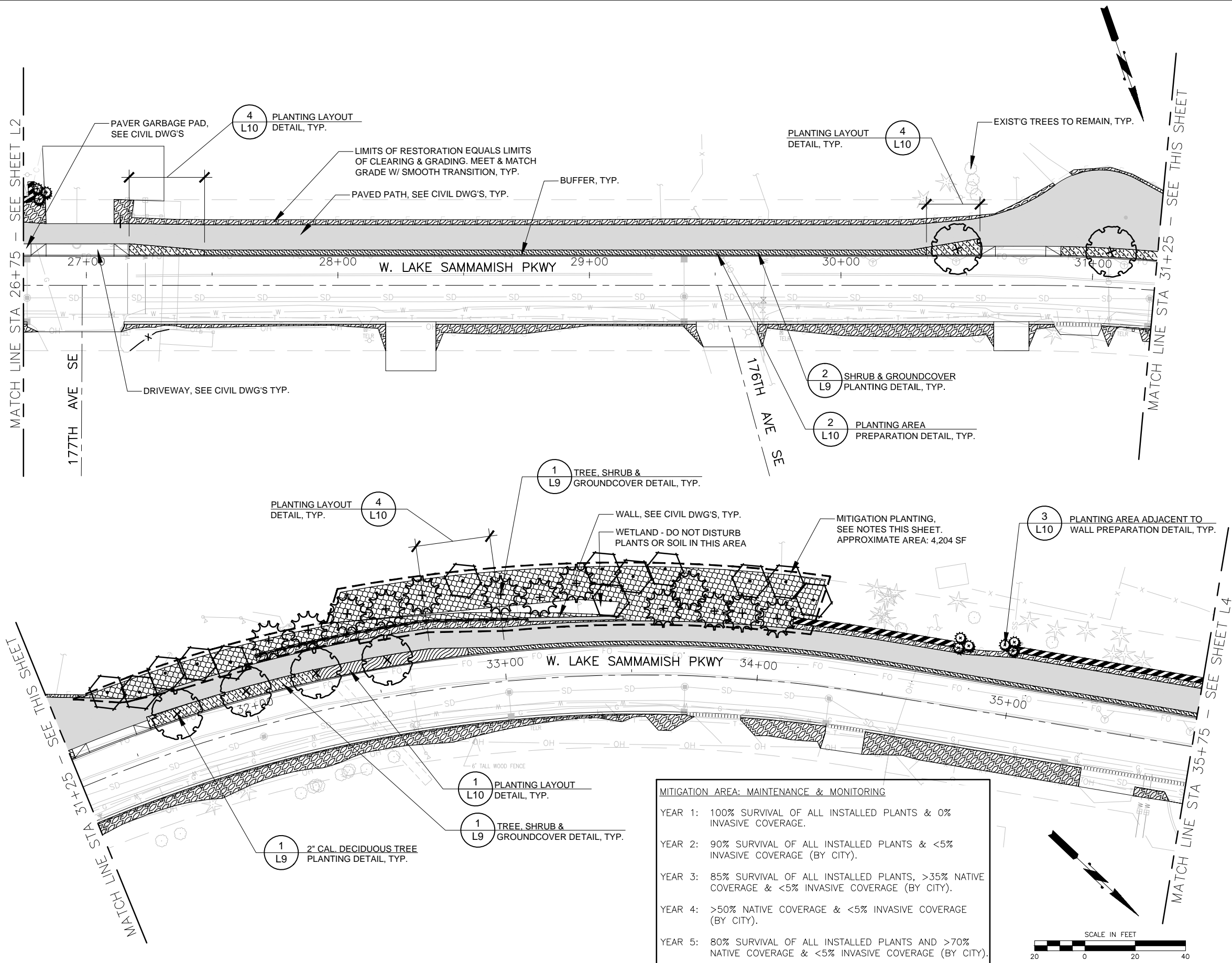

MITIGATION AREA: MAINTENANCE & MONITORING

YEAR 1: 100% SURVIVAL OF ALL INSTALLED PLANTS & 0% INVASIVE COVERAGE.

YEAR 2: 90% SURVIVAL OF ALL INSTALLED PLANTS & <5% INVASIVE COVERAGE (BY CITY).

YEAR 3: 85% SURVIVAL OF ALL INSTALLED PLANTS, >35% NATIVE COVERAGE & <5% INVASIVE COVERAGE (BY CITY).

YEAR 4: >50% NATIVE COVERAGE & <5% INVASIVE COVERAGE (BY CITY).

YEAR 5: 80% SURVIVAL OF ALL INSTALLED PLANTS AND >70% NATIVE COVERAGE & <5% INVASIVE COVERAGE (BY CITY).

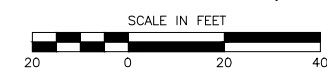

08/06/2012 2:52pm P:\2011 Projects\2011-04\Graphics\AutoCAD\100% Final\PLANT-PLAN.dwg

NO.	DATE	BY	APPR.	REVISIONS

Approved By _____

TRANSPORTATION DESIGN MANAGER DATE _____

PROJECT MANAGER DATE _____

City of Bellevue
 TRANSPORTATION DEPARTMENT

DESIGNED BY **ARL** DATE **AUG 2012**
 DRAWN BY **ARL/MLT** DATE **AUG 2012**
 CHECKED BY **JLH** DATE **AUG 2012**

Reid Middleton
 728 134th Street SW - Suite 200
 Everett, Washington 98204
 Ph: 425 741-3800

WEST LAKE SAMMAMISH PARKWAY
 IMPROVEMENTS PROJECT - PHASE 1

NOTE:
 1. SEE SHEET L8 FOR PLANTING SCHEDULE, LEGEND, NOTES, & ABBREVIATIONS.
 2. WHERE REFERENCED AS CIVIL PLANS/DWG'S REFER TO SHEETS PP1-PP14. (ALL SHEETS WHEN SHOWN)

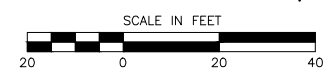
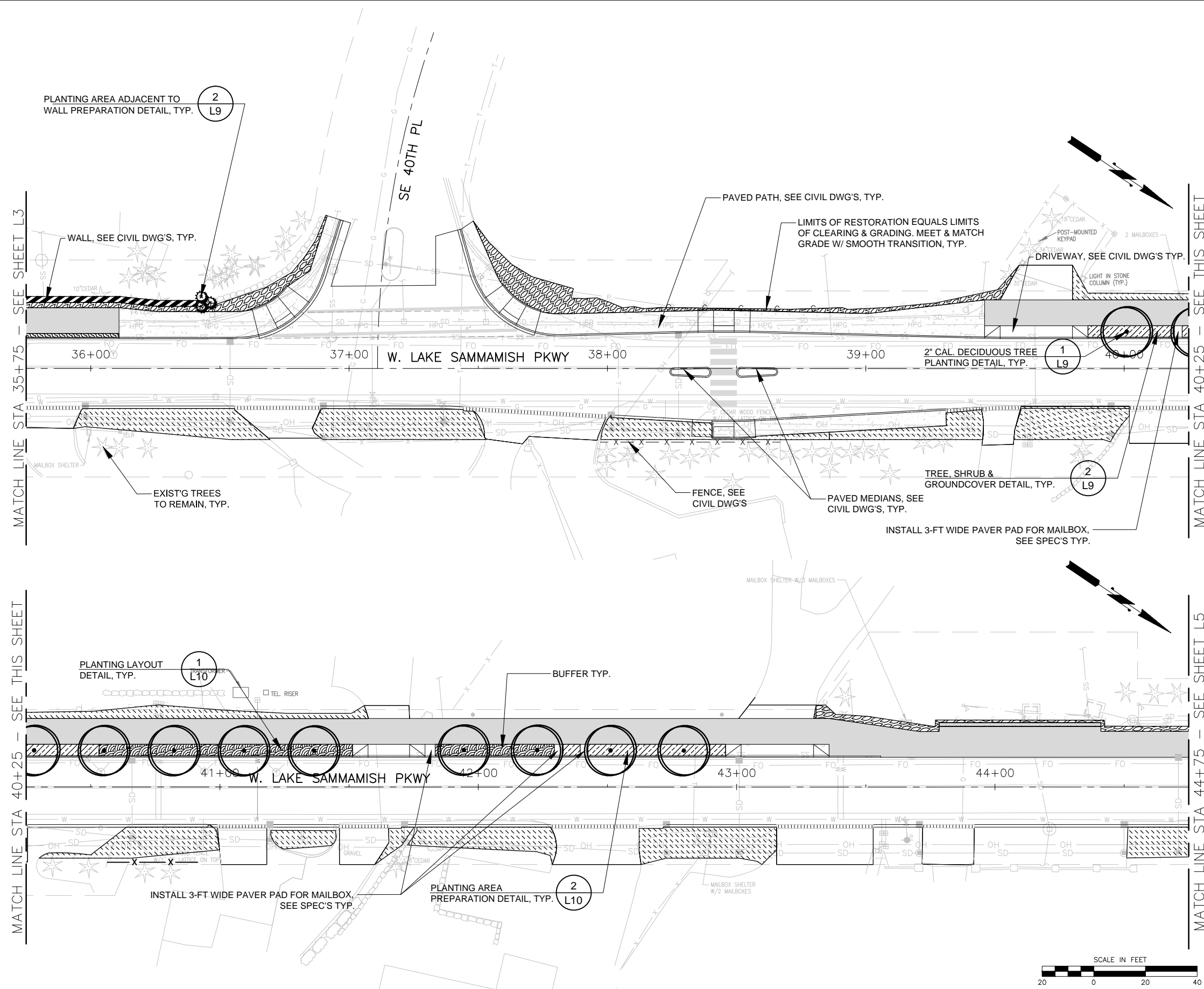

STATE OF WASHINGTON
 LICENSED LANDSCAPE ARCHITECT
 JULIET B. VONG
 LICENSED NO. 857
 EXPIRES ON _____



CALL 48 HOURS BEFORE YOU DIG
 1-800-424-5555

100% SUBMITTAL

PLANTING PLAN

L4 SHT 90 OF 108

08/06/2012 2:52pm P:\2011 Projects\2011-04\Graphics\AutoCAD\100% Final\1-PL01.dwg

NO.	DATE	BY	APPR.	REVISIONS

Approved By
 TRANSPORTATION DESIGN MANAGER DATE
 PROJECT MANAGER DATE

DESIGNED BY ARL DATE AUG 2012
 DRAWN BY ARL/MLT DATE AUG 2012
 CHECKED BY JLH DATE AUG 2012



Reid Middleton
 728 134th Street SW - Suite 200
 Everett, Washington 98204
 Ph: 425 741-3800

WEST LAKE SAMMAMISH PARKWAY
 IMPROVEMENTS PROJECT - PHASE 1

NOTE:
 1. SEE SHEET L8 FOR PLANTING SCHEDULE, LEGEND, NOTES, & ABBREVIATIONS.
 2. WHERE REFERENCED AS CIVIL PLANS/DWG'S REFER TO SHEETS PP1-PP14. (ALL SHEETS WHEN SHOWN)

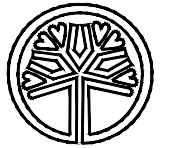
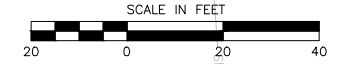
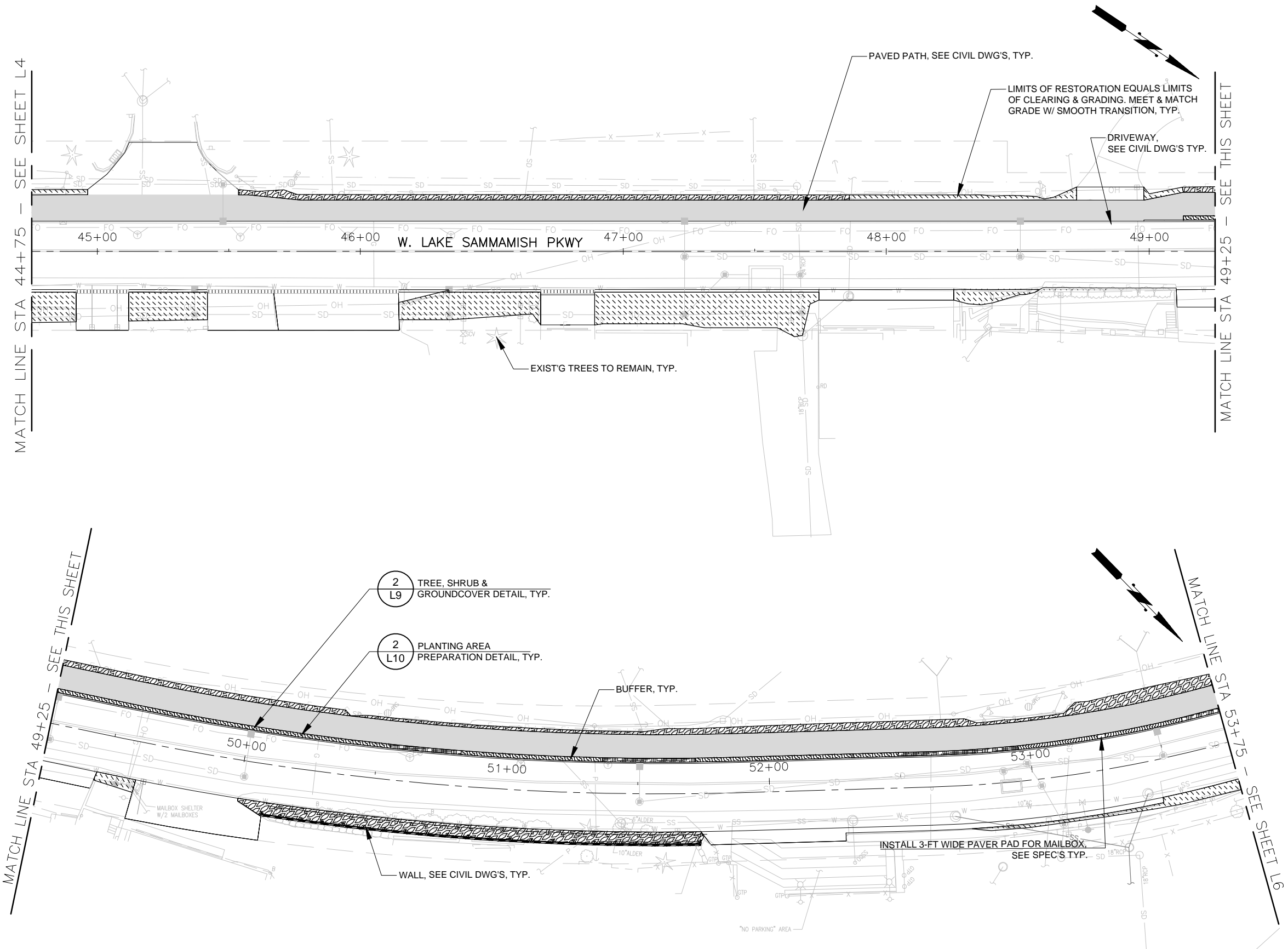

STATE OF WASHINGTON
 LICENSED LANDSCAPE ARCHITECT
 JULIET B. VONG
 LICENSED NO. 857
 EXPIRES ON _____



CALL 48 HOURS BEFORE YOU DIG
 1-800-424-5555

100% SUBMITTAL

PLANTING PLAN

L5 SHT 91 OF 108

08/06/2012 2:52pm P:\2011 Projects\2011-04\Graphics\AutoCAD\100% Final\L-PL01.dwg

NO.	DATE	BY	APPR.	REVISIONS

Approved By
 TRANSPORTATION DESIGN MANAGER DATE
 PROJECT MANAGER DATE

DESIGNED BY ARL/AUG 2012
 DATE ARL/MLT AUG 2012
 DRAWN BY JLH/AUG 2012
 DATE JLH/AUG 2012
 CHECKED BY DATE



Reid Middleton
 728 134th Street SW - Suite 200
 Everett, Washington 98204
 Ph: 425 741-3800

WEST LAKE SAMMAMISH PARKWAY
 IMPROVEMENTS PROJECT - PHASE 1

NOTE:
 1. SEE SHEET L8 FOR PLANTING SCHEDULE, LEGEND, NOTES, & ABBREVIATIONS.
 2. WHERE REFERENCED AS CIVIL PLANS/DWG'S REFER TO SHEETS PP1-PP14. (ALL SHEETS WHEN SHOWN)

MATCH LINE STA 53+75 - SEE SHEET L5

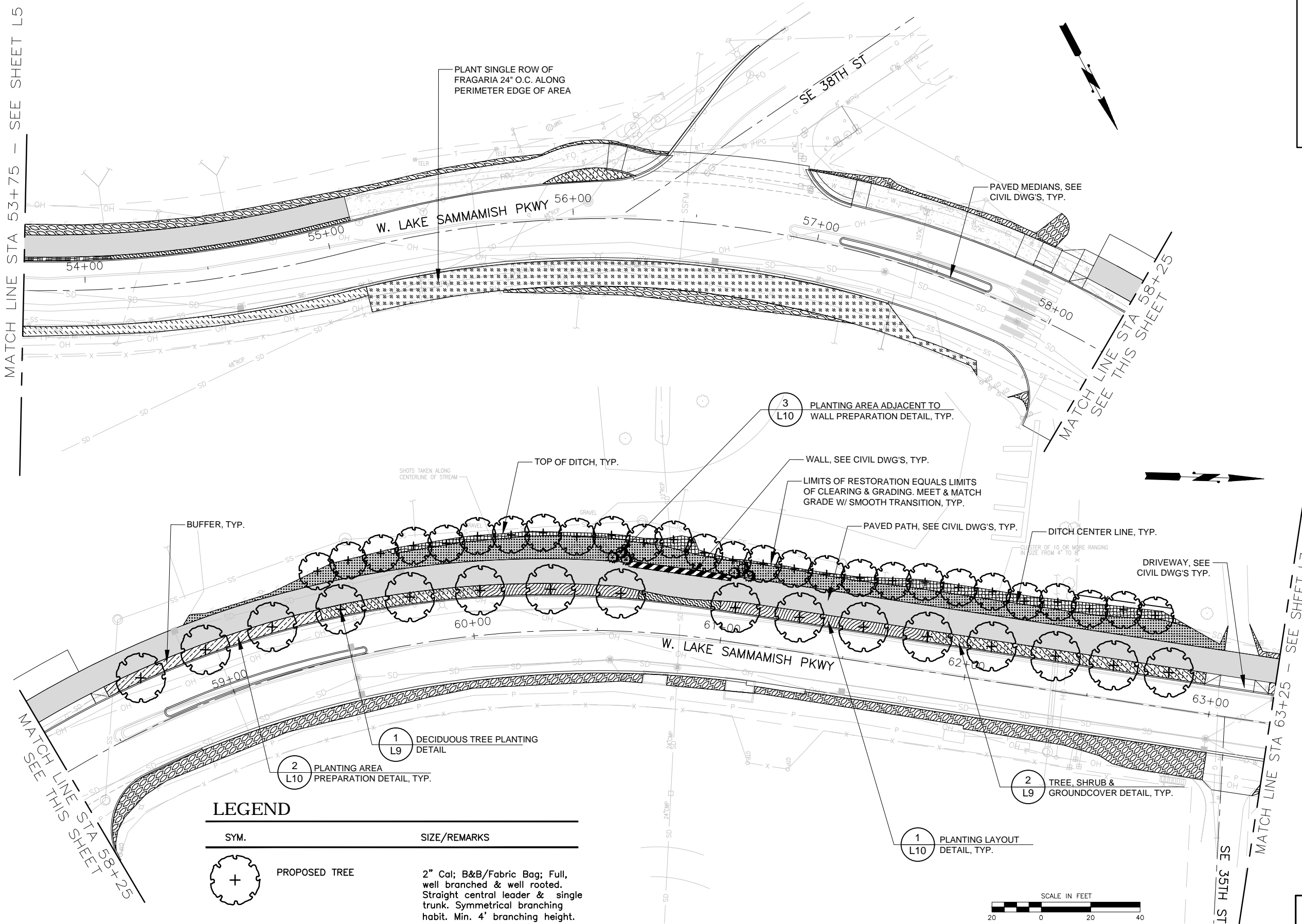

LEGEND

SYM.	SIZE/REMARKS
	PROPOSED TREE 2" Cal; B&B/Fabric Bag; Full, well branched & well rooted. Straight central leader & single trunk. Symmetrical branching habit. Min. 4' branching height.

- 1 L9 DECIDUOUS TREE PLANTING DETAIL
- 2 L10 PLANTING AREA PREPARATION DETAIL, TYP.
- 3 L10 PLANTING AREA ADJACENT TO WALL PREPARATION DETAIL, TYP.

- 1 L10 PLANTING LAYOUT DETAIL, TYP.
- 2 L9 TREE, SHRUB & GROUNDCOVER DETAIL, TYP.



08/06/2012 2:52pm P:\2011 Projects\2011-04\Graphics\AutoCAD\100% Final\1-PL01.dwg

NO.	DATE	BY	APPR.	REVISIONS

Approved By	
TRANSPORTATION DESIGN MANAGER	DATE
PROJECT MANAGER	DATE

City of Bellevue
 TRANSPORTATION DEPARTMENT

Reid Middleton
 728 134th Street SW - Suite 200
 Everett, Washington 98204
 Ph: 425 741-3800

WEST LAKE SAMMAMISH PARKWAY IMPROVEMENTS PROJECT - PHASE 1



STATE OF WASHINGTON
 LICENSED LANDSCAPE ARCHITECT
 JULIET B. VONG
 LICENSED NO. 857
 EXPIRES ON _____

HBB
 LANDSCAPE ARCHITECTURE
 215 WESTLAKE AVENUE NORTH SEATTLE, WA 98109

CALL 48 HOURS BEFORE YOU DIG
 1-800-424-5555

100% SUBMITTAL

PLANTING PLAN	
L6	SHT 92 OF 108

NOTE:
 1. SEE SHEET L8 FOR PLANTING SCHEDULE, LEGEND, NOTES, & ABBREVIATIONS.
 2. WHERE REFERENCED AS CIVIL PLANS/DWG'S REFER TO SHEETS PP1-PP14. (ALL SHEETS WHEN SHOWN)

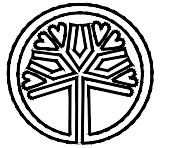
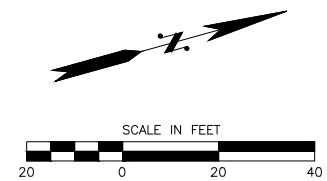
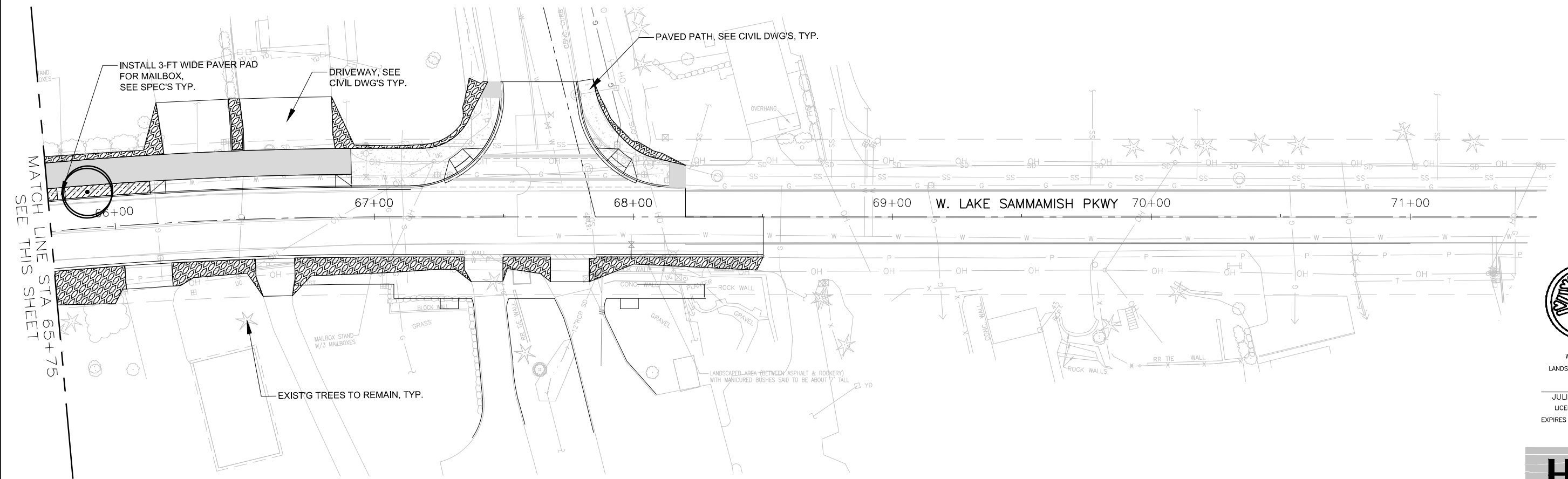
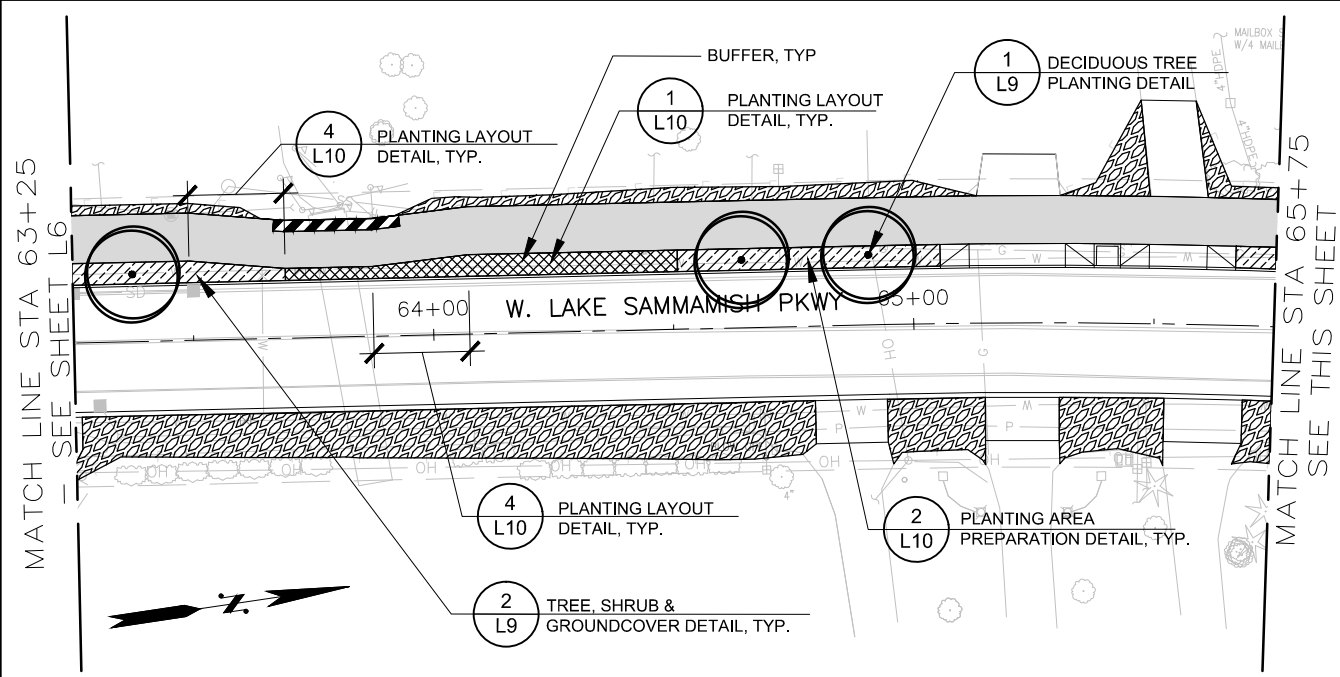

STATE OF WASHINGTON
 LICENSED LANDSCAPE ARCHITECT
 JULIET B. VONG
 LICENSED NO. 857
 EXPIRES ON _____



CALL 48 HOURS BEFORE YOU DIG
 1-800-424-5555

100% SUBMITTAL

PLANTING PLAN

L7 SHT 93 OF 108

08/06/2012 2:52pm P:\2011 Projects\2011-04\Graphics\AutoCAD\100% Final\1-PL01.dwg

NO.	DATE	BY	APPR.	REVISIONS

Approved By
 TRANSPORTATION DESIGN MANAGER DATE
 PROJECT MANAGER DATE

DESIGNED BY **ARL** DATE **AUG 2012**
 DRAWN BY **ARL/MLT** DATE **AUG 2012**
 CHECKED BY **JLH** DATE **AUG 2012**



Reid Middleton
 728 134th Street SW - Suite 200
 Everett, Washington 98204
 Ph: 425 741-3800

WEST LAKE SAMMAMISH PARKWAY
 IMPROVEMENTS PROJECT - PHASE 1

PLANTING SCHEDULE

SYM.	QTY.	SCIENTIFIC/Common Name	SIZE/REMARKS	SYM.	QTY.	SCIENTIFIC/Common Name	SIZE	SPACING/POSITION	GROUPING NUMBERS	REMARKS	SHRUB/GROUND COVER	DETAIL LAYOUT REFERENCE
TREES				SHRUBS & GROUND COVER								
	28	Acer truncatum x Acer plantanoides 'Warrenred' / PACIFIC SUNSET MAPLE	2" Cal; B&B/Fabric Bag; Full, well branched & well rooted. Straight central leader & single trunk. Symmetrical branching habit. Min. 4' branching height.		86	Symphoricarpos x chanaultii 'Hancock' / HANCOCK SNOWBERRY	2 Gal. Cont.	54" O.C., Single row at center of planter.	N/A	Full, well branched & well rooted.	Shrub	
	23	Cornus kousa x Cornus nuttallii 'Starlight' / STARLIGHT DOGWOOD	2" Cal; B&B/Fabric Bag; Full, well branched & well rooted. Straight central leader & single trunk. Symmetrical branching habit. Min. 4' branching height.		414	Epimedium x versicolor 'Sulphureum' / SULPHUREUM BARRENWORT	1 Gal. Cont.	24" O.C., Single row adjacent to curb & path.	N/A			
	22	Nyssa sylvatica 'Red Rage' / RED RAGE TUPELO	2" Cal; B&B/Fabric Bag; Full, well branched & well rooted. Straight central leader & single trunk. Symmetrical branching habit. Min. 4' branching height.		240	Cornus sericea 'Kelseyi' / KELSEYI DOGWOOD	2 Gal. Cont.	24" O.C., Single row at center of planter.	10-15			
WETLAND BUFFER TREES					122	Prunus laurocerasus 'Mt. Vernon' / MT. VERNON ENGLISH LAUREL	2 Gal. Cont.	48" O.C., Single row at center of planter.	6-10			
	13	Thuja plicata / WESTERN RED CEDAR	2 Gal. Cont. Full, well branched & well rooted. Straight central leader & single trunk. Symmetrical branching habit.		1,007	Fragaria chiloensis / BEACH STRAWBERRY	4" Pot	24" O.C., Single row adjacent to curb & path.	N/A			
	13	Acer macrophyllum / BIG LEAF MAPLE	2 Gal. Cont. Full, well branched & well rooted. Straight central leader & single trunk. Symmetrical branching habit.		75	Mahonia nervosa / LOW OREGON GRAPE	2 Gal. Cont.	24" O.C., Single row at center of planter.	N/A			
					151	Epimedium x versicolor 'Sulphureum' / SULPHUREUM BARRENWORT	1 Gal. Cont.	24" O.C., Single row adjacent to curb & path.	N/A			
					189	Cornus sericea 'Kelseyi' / KELSEYI DOGWOOD	2 Gal. Cont.	36" O.C., Triangular spacing. Min. 12" offset from curb & path.	5-10			
					281	Mahonia repens / CREEPING MAHONIA	2 Gal. Cont.	24" O.C., Triangular spacing. Min. 12" offset from curb & path.	15-20			
					264	Fragaria chiloensis / BEACH STRAWBERRY	4" Pot	24" O.C., Single row adjacent to curb & perimeter edge	N/A			
					49	Vaccinium ovatum / EVERGREEN HUCKLEBERRY	2 Gal. Cont.	54" O.C., Single row at center of planter.	N/A			
					211	Epimedium x versicolor 'Sulphureum' / SULPHUREUM BARRENWORT	1 Gal. Cont.	24" O.C., Single row adjacent to curb & path.	N/A			
					80	Gaultheria shallon / SALAL	1 Gal. Cont.	24" O.C., Single row at center of planter.	N/A			
					440	Mahonia repens / CREEPING MAHONIA	2 Gal. Cont.	18" O.C., Single row at center of planter.	14-34			
					292	Cornus sericea 'Kelseyi' / KELSEYI DOGWOOD	2 Gal. Cont.	24" O.C., Single row at center of planter.	12-30			
					190	Polystichum munitum / SWORD FERN	1 Gal. Cont.	24" O.C., Triangular spacing. Min. 12" offset from curb & path.	12-18			
					119	Blechnum spicant / DEER FERN	1 Gal. Cont.	24" O.C., Triangular spacing. Min. 12" offset from curb & path.	6-10			
					47	Dryopteris lepidopoda / SUNSET FERN	1 Gal. Cont.	24" O.C., Triangular spacing. Min. 24" offset from curb.	4-8			
					94	Oxalis oregana / REDWOOD SORREL	1 Gal. Cont.	12" O.C., Triangular spacing. Min. 12" offset from path.	4-6			
					94	Vancouveria hexandra / WHITE INSIDEOUT FLOWER	1 Gal. Cont.		4-6			
					94	Trillium ovatum / COAST TRILLIUM	1 Gal. Cont.		4-6			
					189	Cornus canadensis / BUNCHBERRY	1 Gal. Cont.		4-6			
					168	Polystichum munitum / SWORD FERN	1 Gal. Cont.	24" O.C., Triangular spacing. Min. 12" offset from curb & path.	2-3			
					168	Fragaria chiloensis / BEACH STRAWBERRY	4" Pot	24" O.C., Triangular spacing. Min. 12" offset from curb & path.	2-3			
					235	Cornus sericea 'Kelseyi' / KELSEYI DOGWOOD	2 Gal. Cont.	24" O.C., Triangular spacing. Min. 12" offset from curb.	4-6			
					101	Iris 'Pacific Coast Hybrids' / PACIFIC COAST IRIS	1 Gal. Cont.	24" O.C., Triangular spacing. Min. 12" offset from path.	8-10			
					21	Vaccinium ovatum / EVERGREEN HUCKLEBERRY	5 Gal. Cont.	As shown on plan, Min. 12" offset from retaining wall	N/A			
					8	Ribes sanguineum / RED-FLOWERING CURRANT	2 Gal. Cont.	54" O.C., Triangular spacing.	4-6			
					8	Vaccinium ovatum / EVERGREEN HUCKLEBERRY	2 Gal. Cont.	54" O.C., Triangular spacing.	6-8			
					36	Polystichum munitum / SWORD FERN	1 Gal. Cont.	24" O.C., Triangular spacing.	12-18			
					8	Symphoricarpos alba / COMMON SNOWBERRY	2 Gal. Cont.	54" O.C., Triangular spacing.	4-6			
					106	Mahonia repens / CREEPING MAHONIA	2 Gal. Cont.	18" O.C., Triangular spacing.	12-18			
					4	Morella californica / PACIFIC WAX MYRTLE	5 Gal. Cont.	72" O.C., Triangular spacing.				
					55	Acer circinatum / VINE MAPLE	1 Gal. Cont.	36" O.C., Triangular spacing. Min. 36" offset from path.	2-3			
					55	Corylus cornuta / BEAKED HAZELNUT	1 Gal. Cont.	36" O.C., Triangular spacing. Min. 36" offset from path.	2-3			
					75	Rubus spectabilis / SALMONBERRY	1 Gal. Cont.	36" O.C., Triangular spacing. Min. 36" offset from path.	4-6			
					55	Polystichum munitum / SWORD FERN	1 Gal. Cont.	36" O.C., Triangular spacing. Min. 18" offset from path.	4-6			
					20	Lonicera involucrata / BLACK TWINBERRY	1 Gal. Cont.	36" O.C., Triangular spacing. Min. 36" offset from path.	2-3			
					2,470	S.Y. Seeding, Fertilizing & Mulching	N/A	N/A	N/A			
					90	C.Y. Bark Mulch (3" DEPTH)	N/A	N/A	N/A			
					303	S.Y. Seed	N/A	N/A	N/A			
OTHER				WETLAND MITIGATION TREES, SHRUBS & GROUND COVER								
					55	Acer circinatum / VINE MAPLE	1 Gal. Cont.	36" O.C., Triangular spacing. Min. 36" offset from path.	2-3			
					55	Corylus cornuta / BEAKED HAZELNUT	1 Gal. Cont.	36" O.C., Triangular spacing. Min. 36" offset from path.	2-3			
					75	Rubus spectabilis / SALMONBERRY	1 Gal. Cont.	36" O.C., Triangular spacing. Min. 36" offset from path.	4-6			
					55	Polystichum munitum / SWORD FERN	1 Gal. Cont.	36" O.C., Triangular spacing. Min. 18" offset from path.	4-6			
					20	Lonicera involucrata / BLACK TWINBERRY	1 Gal. Cont.	36" O.C., Triangular spacing. Min. 36" offset from path.	2-3			
					2,470	S.Y. Seeding, Fertilizing & Mulching	N/A	N/A	N/A			
					90	C.Y. Bark Mulch (3" DEPTH)	N/A	N/A	N/A			
					303	S.Y. Seed	N/A	N/A	N/A			

PLANTING LEGEND



1
L9
DETAIL IDENTIFICATION SHEET IDENTIFICATION

▲ Planting shall be mixed in irregular patterns with spacing & group sizes shown on schedule. See Sample Informal Planting Layout Detail 5, Sheet L9.

PLANTING ABBREVIATIONS

#	NUMBER	MIN.	MINIMUM
%	PERCENT	N/A	NOT APPLICABLE
&	AND	NTS	NOT TO SCALE
APPROX.	APPROXIMATE	O.C.	ON CENTER
B&B	BALLED AND BURLAPPED	PCH	PACIFIC COAST HYBRIDS
CL	CENTER LINE	PKWY	PARKWAY
CAL.	CALIPER	PREP	PREPARATION
CONT.	CONTAINER	QTY.	QUANTITY
DIA.	DIAMETER	SPECS	SPECIFICATIONS
DWG, DWG'S	DRAWING(S)	STA.	STATION
ENG.	ENGINEER	SYM.	SYMBOL
EQ.	EQUAL	TYP.	TYPICAL
EXIST'G	EXISTING	W/	WITH
GAL.	GALLON		
HT.	HEIGHT		
L.F.	LINEAR FEET		
MAX.	MAXIMUM		
MFR'S	MANUFACTURERS		

PLANTING NOTES

- ANY DISCREPANCIES W/ THE DRWG'S AND/OR SPEC'S & SITE CONDITIONS SHALL BE BROUGHT TO THE ATTENTION OF ENG. PRIOR TO PROCEEDING W/ CONSTRUCTION.
- THE CONTRACTOR IS RESPONSIBLE FOR LOCATING UTILITIES PRIOR TO BEGINNING CONSTRUCTION
- PLANT MATERIAL LOCATIONS SHALL BE COORDINATED W/ SPRINKLER IRRIGATION HEAD LOCATIONS TO AVOID ANY CONFLICTS.
- LANDSCAPE CONTRACTOR SHALL BE RESPONSIBLE FOR ANY COORDINATION W/ SUB-CONTRACTORS AS REQUIRED TO ACCOMPLISH PLANTING OPERATIONS.
- FIELD STAKE ALL TREES, SHRUB, AND GROUND COVER PLANTING LOCATIONS FOR ENGINEER REVIEW AND APPROVAL PRIOR TO PLANTING
- PLANTING DRAWING IS BASED UPON BASE DRAWINGS DATED 07/31/2012. PREPARED BY:
REID MIDDLETON
728 134TH ST. SW, SUITE 200
(425)-741-3800
- SHRUB AND GROUND COVER ADJACENT TO MAILBOXES TO BE OFFSET 18" FROM EDGE OF PAVERS AROUND MAILBOX.
- TREE LOCATIONS SHOWN ON PLANTING PLANS (SHEETS L1 TO L7) ARE APPROX. IF FIELD ADJUSTMENTS ARE NECESSARY, THE FOLLOWING MIN. SETBACKS FOR CENTERLINE OF TREE TRUNKS SHALL APPLY:

A. STREET LIGHTS	10'
B. DRIVEWAYS	10'
C. INTERSECTIONS	30'
D. UNDERGROUND SEWER & WATER LINES	5'
E. UNDERGROUND GAS LINES	1'
F. UNDERGROUND HIGH PRESSURE GAS LINES	3'
G. UTILITY/POWER POLES	5'
H. UNDERGROUND FIBER CABLE	2'
I. OTHER TREES	15'
J. FACE OF CURB	3'

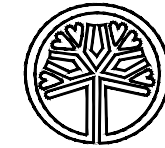

STATE OF WASHINGTON
LICENSED
LANDSCAPE ARCHITECT

JULIE B. VONG
LICENSED NO. 857
EXPIRES ON _____



CALL 48 HOURS BEFORE YOU DIG
1-800-424-5555

100% SUBMITTAL

NO.	DATE	BY	APPR.	REVISIONS	APPROVED BY	DATE	DESIGNED BY	DATE	CITY OF BELLEVUE	TRANSPORTATION DESIGN MANAGER	DATE	TRANSPORTATION DEPARTMENT	DESIGNED BY	DATE	REID MIDDLETON	728 134th Street SW - Suite 200 Everett, Washington 98204 Ph: 425 741-3800	WEST LAKE SAMMAMISH PARKWAY IMPROVEMENTS PROJECT - PHASE 1	PLANTING SCHEDULE, LEGEND, ABBREVIATIONS, & NOTES	L8	SHT <u>94</u> OF 108

08/06/2012 2:52pm P:\2011 Projects\2011-04\Graphics\AutoCAD\100% Final\1-PL01.dwg

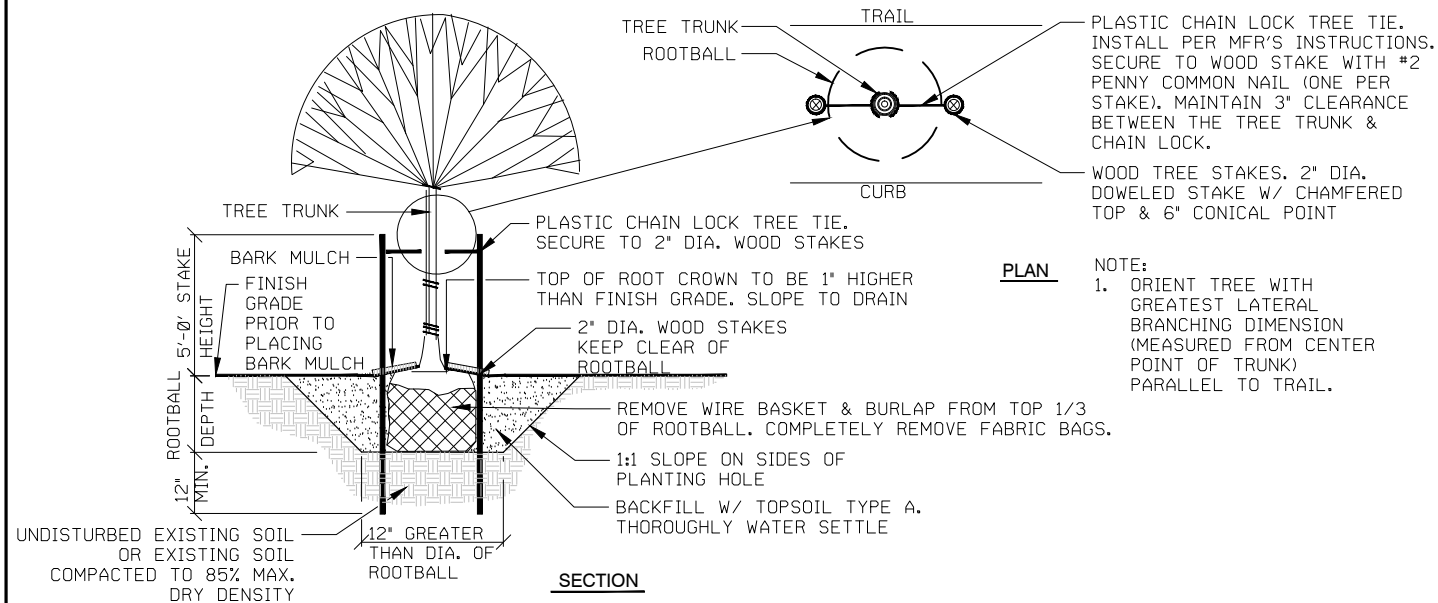

1 2" CAL. DECIDUOUS TREE PLANTING DETAIL
NTS

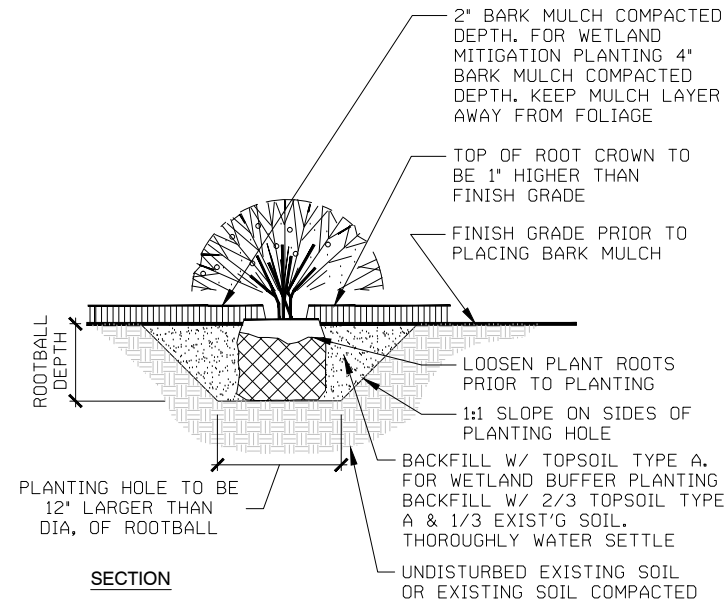

2 TREE, SHRUB & GROUND COVER DETAIL
NTS

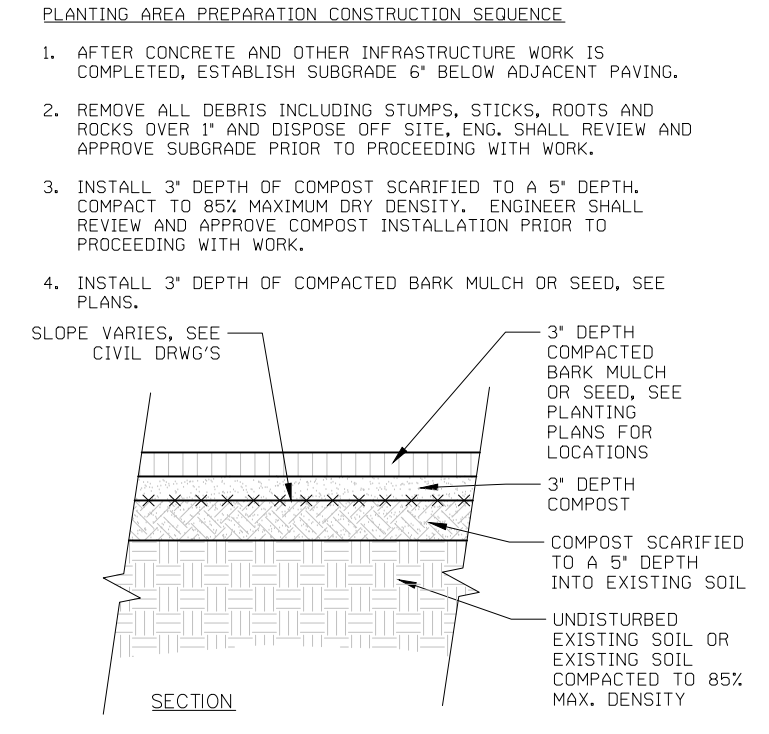

3 RESTORATION PREPARATION DETAIL
NTS

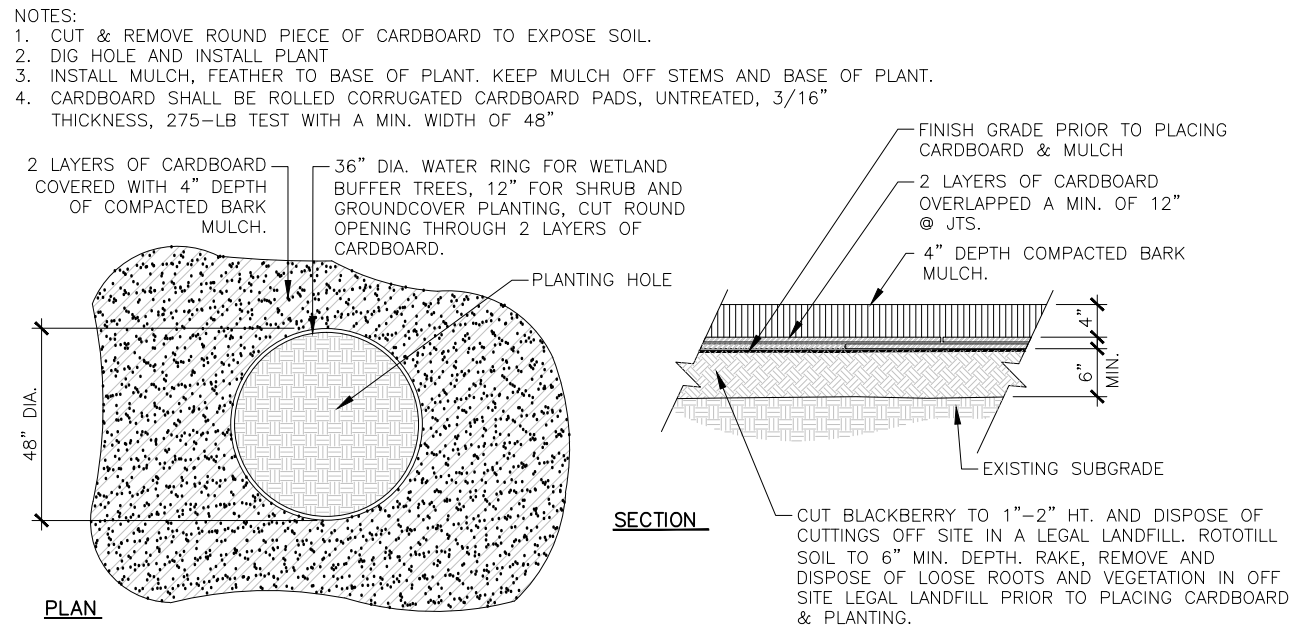

4 BLACKBERRY REMOVAL PLANTING DETAIL
NTS

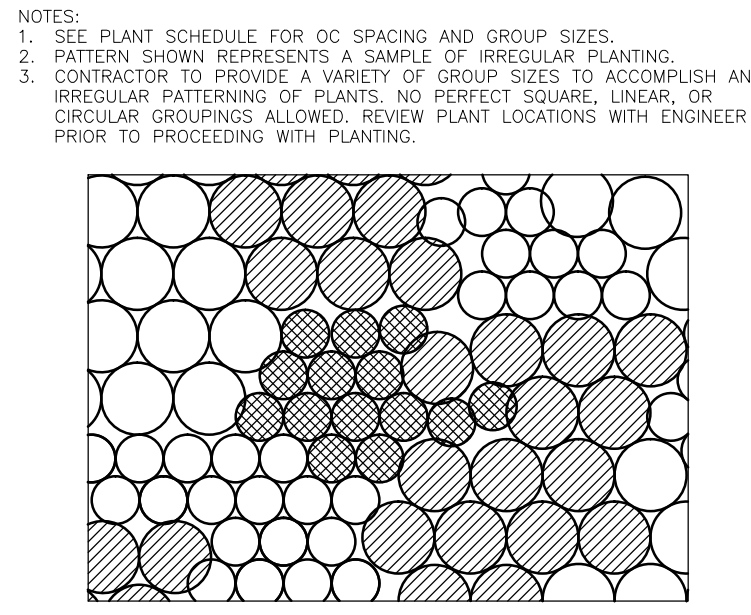

5 SAMPLE INFORMAL PLANTING LAYOUT
NTS

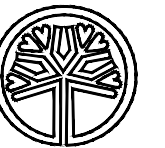

STATE OF WASHINGTON
LICENSED
LANDSCAPE ARCHITECT

JULIET B. VONG
LICENSED NO. 857
EXPIRES ON _____



CALL 48 HOURS BEFORE YOU DIG
1-800-424-5555

08/06/2012 2:52pm P:\2011 Projects\2011-04\Graphics\AutoCAD\100% Final\1-PL01.dwg

NO.	DATE	BY	APPR.	REVISIONS

Approved By		
TRANSPORTATION DESIGN MANAGER	DATE	ARL DESIGNED BY AUG 2012 DATE
PROJECT MANAGER	DATE	ARL/MLT DRAWN BY AUG 2012 DATE
		JLH CHECKED BY AUG 2012 DATE

CITY OF BELLEVUE
City of Bellevue
TRANSPORTATION DEPARTMENT

Reid Middleton
728 134th Street SW - Suite 200
Everett, Washington 98204
Ph: 425 741-3800

WEST LAKE SAMMAMISH PARKWAY
IMPROVEMENTS PROJECT - PHASE 1

100% SUBMITTAL	
PLANTING DETAILS	
L9	SHT <u>95</u> OF 108

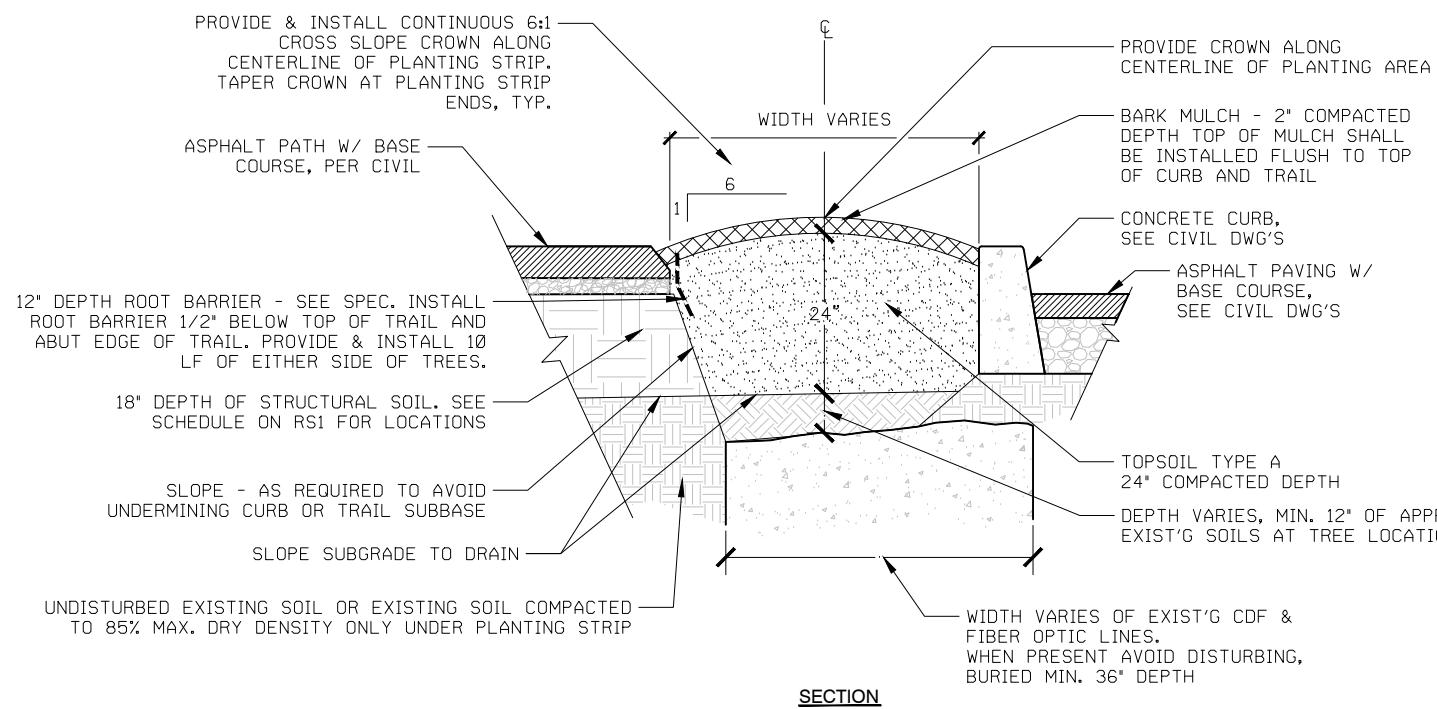
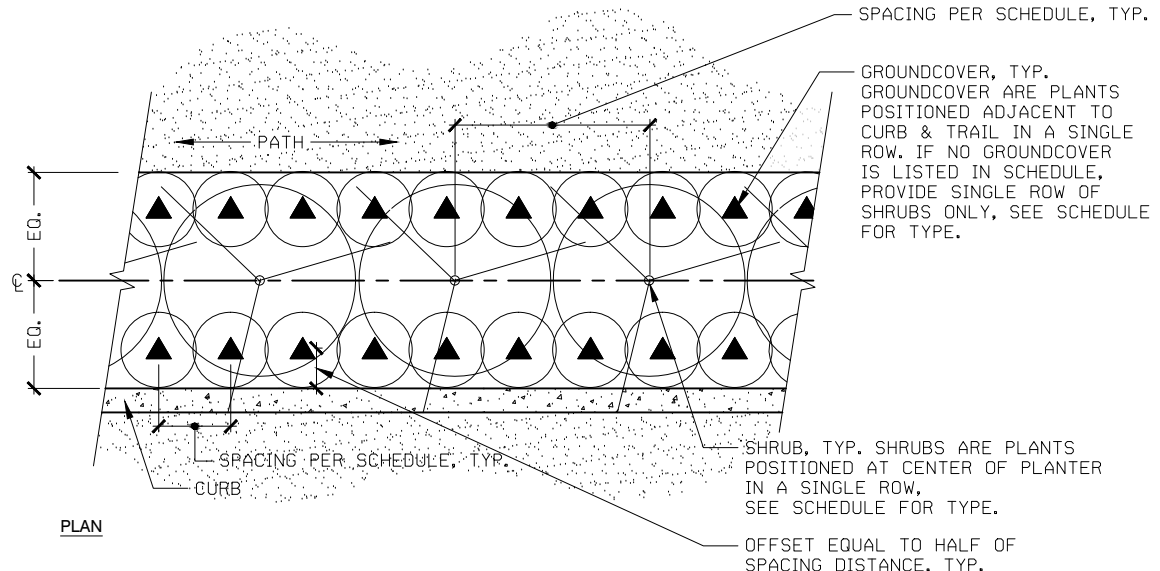

- SOIL PREPARATION CONSTRUCTION SEQUENCE**
1. AFTER CONCRETE AND OTHER INFRASTRUCTURE WORK IS COMPLETED, ESTABLISH SUBGRADE MINIMUM 38" FOR TREES, 26" FOR SHRUBS & GROUNDCOVER, ADJACENT TOP OF CURB AND TRAIL.
 2. REMOVE ALL DEBRIS INCLUDING STUMPS, STICKS, ROOTS AND ROCKS OVER 1" AND DISPOSE OFF SITE, ENGINEER SHALL REVIEW AND APPROVE SUBGRADE PRIOR TO PROCEEDING WITH WORK.
 3. PLACE 6" COMPACTED DEPTH OF TOP SOIL TYPE A AND THOROUGHLY SCARIFY TO A DEPTH OF 6". THOROUGHLY WATER SETTLE WHERE CDF & FIBER OPTIC WIRES ARE NOT PRESENT.
 4. INSTALL 6" LIFTS OF TOP SOIL TYPE A AND COMPACT TO 85% MAXIMUM DRY DENSITY. ENGINEER SHALL REVIEW AND APPROVE TOPSOIL INSTALLATION PRIOR TO PROCEEDING WITH WORK.
 5. INSTALL PLANT MATERIALS PER DETAILS.
 6. INSTALL 2" COMPACTED DEPTH OF BARK MULCH.

1 PLANTING LAYOUT DETAIL
NTS

2 PLANTING AREA PREPARATION DETAIL
NTS

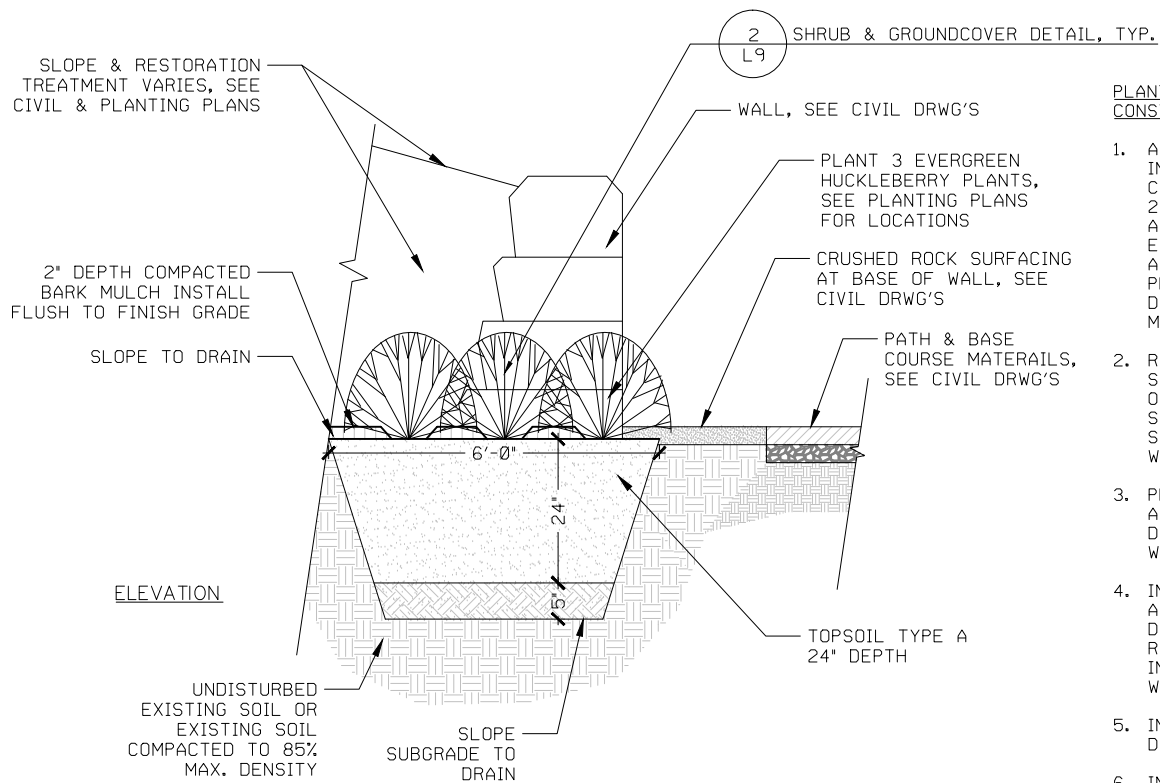

- PLANTING AREA PREPARATION CONSTRUCTION SEQUENCE**
1. AFTER CONCRETE AND OTHER INFRASTRUCTURE WORK IS COMPLETED, ESTABLISH SUBGRADE 26" BELOW WITHIN IN AN 6' AREA ADJACENT TO ENDS OF WALLS WHERE EVERGREEN HUCKLEBERRY PLANTS ARE TO BE LOCATED, SEE LANDSCAPE PLANS FOR LOCATIONS. AVOID DISTURBING WALL BASE COURSE MATERIALS.
 2. REMOVE ALL DEBRIS INCLUDING STUMPS, STICKS, ROOTS AND ROCKS OVER 1" AND DISPOSE OFF SITE, ENG. SHALL REVIEW AND APPROVE SUBGRADE PRIOR TO PROCEEDING WITH WORK.
 3. PLACE 6" DEPTH OF TOPSOIL TYPE A AND THOROUGHLY SCARIFY TO A 5" DEPTH INTO SUBGRADE, THOROUGHLY WATER SETTLE.
 4. INSTALL 6" LIFTS OF TOPSOIL TYPE A AND COMPACT TO 85% MAXIMUM DRY DENSITY. ENGINEER SHALL REVIEW AND APPROVE TOPSOIL INSTALLATION PRIOR TO PROCEEDING WITH WORK.
 5. INSTALL PLANT MATERIALS PER DETAILS.
 6. INSTALL 2" DEPTH OF COMPACTED BARK MULCH.

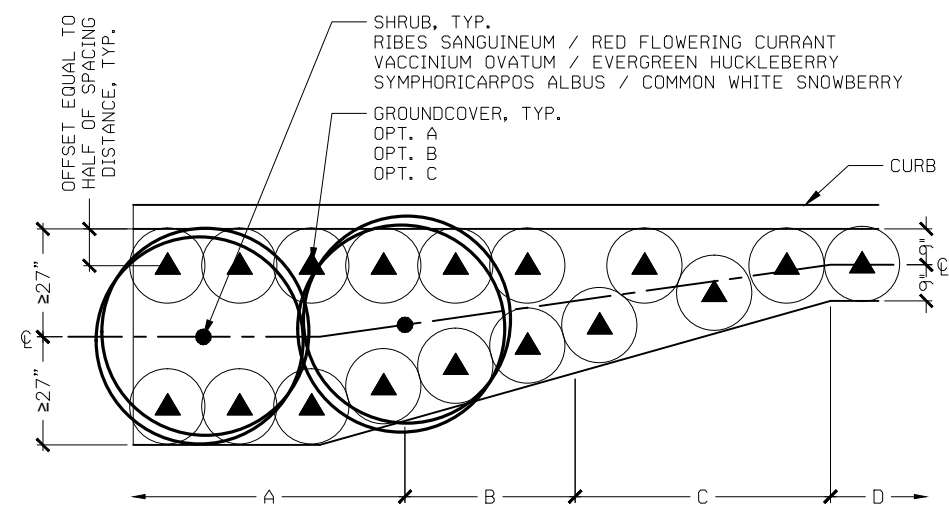

- A. PLANTER WIDTH: <48" SHRUB: SINGLE ROW AT CENTER OF PLANTER; SPACING PER SCHEDULE GROUNDCOVER: SINGLE ROW ADJACENT TO CURB AND TRAIL SPACING PER SCHEDULE
- B. PLANTER WIDTH: >48" AND <36" SHRUB: NONE GROUNDCOVER: SINGLE ROW ADJACENT TO CURB AND TRAIL; SPACING PER SCHEDULE
- C. PLANTER WIDTH: >36" AND <18" SHRUB: NONE GROUNDCOVER: TRIANGULAR SPACING PER SCHEDULE
- D. PLANTER WIDTH: 18" SHRUB: NONE GROUNDCOVER: SINGLE ROW; SPACING PER SCHEDULE

3 PLANTING AREA ADJACENT TO WALL PREPARATION DETAIL
NTS

4 PLANTING LAYOUT DETAIL
NTS

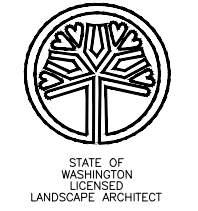

JULIET B. VONG
LICENSED NO. 857
EXPIRES ON _____



CALL 48 HOURS BEFORE YOU DIG
1-800-424-5555

100% SUBMITTAL

PLANTING DETAILS

L10 SHT 96 OF 108

08/06/2012 2:52pm P:\2011 Projects\2011-04\Graphics\AutoCAD\100% Final\1-PL01.dwg

NO.	DATE	BY	APPR.	REVISIONS

Approved By		
TRANSPORTATION DESIGN MANAGER	DATE	ARL DESIGNED BY AUG 2012
PROJECT MANAGER	DATE	ARL/MLT DRAWN BY AUG 2012
		JLH CHECKED BY AUG 2012

City of Bellevue
TRANSPORTATION DEPARTMENT

Reid Middleton
728 134th Street SW - Suite 200
Everett, Washington 98204
Ph: 425 741-3800

WEST LAKE SAMMAMISH PARKWAY IMPROVEMENTS PROJECT - PHASE 1